

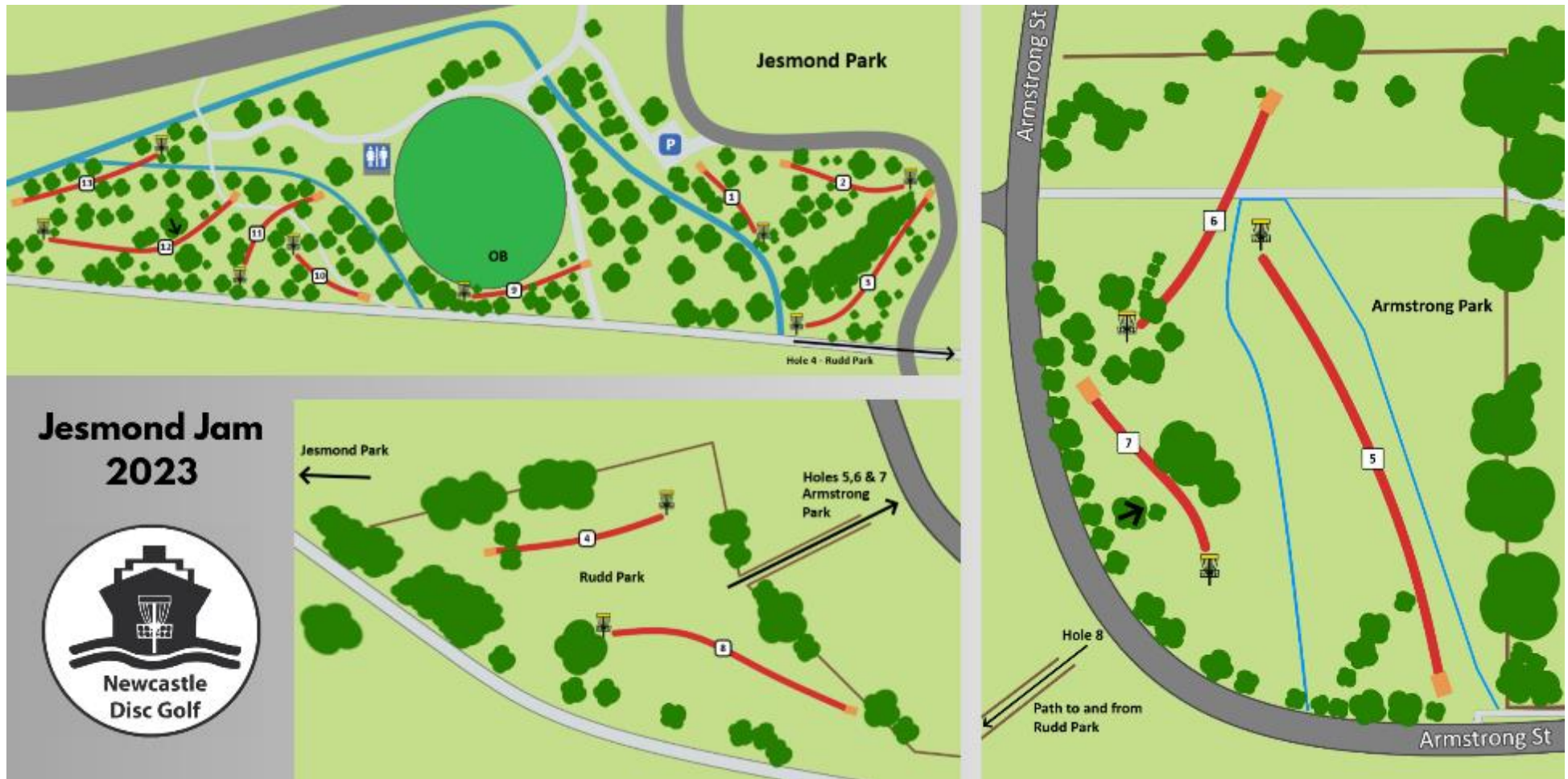

JESMOND JAM 2023 CADDY BOOK



Jam 2023 across 3 Parks



Welcome and Schedule

We're looking forward to seeing you at our 12th annual Jesmond Jam tournament with great groups competing in different division on both days. This is the largest field of players pre-registered that we've ever had – if you know that you won't be able to make it, please let us know before the event.

Saturday has MP40, MA2, MA3, MA4, FA2, FA4, MJ15, FJ15 divisions competing

Sunday has MPO, FPO, MA1, FA1, MA40, MA50, FA40 divisions competing

The schedule is the same for both days:

8:30am-9:15am – Check in and practice time

9:15-9:45am - Mandatory players meeting

10:00am - First round of 13 holes

12:00pm – 1:00pm BYO Lunch (approximate, 1 hour from when final group finishes round 1)

Second round of 13 holes after lunch

4:00pm Playoffs (if required) and Presentations

We will be using PDGA for scoring, 2 players on each card to score, it will be available at:

www.pdga.com/score (Access code = SaturdayJam and SundayJam)

Note that lunch will not be provided. We will have some muesli bars and fruit for free.

Hole by Hole Notes

Roads, cycleway behind park and beyond, oval and drains are OB on all holes.
Over drains is OB unless the tee and pin are on different sides of the drain.
Pathways through the park NOT OB unless stated below.

Hole 1 (Blue Tee) Par 3 - 63m

OB in and over drain on right hand side. Casual water might come into play with pool of water short of the basket.



Hole 2 (Red Tee) Par 3 - 76m

OB along left and beyond the hole past bollards.



Hole 3 (Black Tee) Par 4 - 122m

OB on and beyond cycleway, road on left beyond bollards and drain beyond the hole.



Hole 4 (Rudd Park 1) Par 3 - 65m

OB over fences.



Hole 5 (Armstrong Park 1) Par 4 - 133m

OB marked with flags left, right and behind basket.



Hole 6 (Armstrong Park 2) Par 3 - 80m

OB on left marked with flags, road behind basket and beyond OB.



Hole 7 (Armstrong Park 3) Par 3 - 75m

Mando to left of marked tree. OB on left marked with flags, road and beyond OB.



Hole 8 (Rudd Park) Par 3 - 76m

OB over fences and cycle path to the far left and beyond.



Hole 9 (Blue Tee) Par 3 - 72m

OB on cycleway and beyond to the left. OB on oval, defined by fence line. Watch for people. Fenced area with pipes is also OB.



Hole 10 (Blue Tee) Par 3 - 69m

OB on cycleway to the left and beyond. Watch for people on path.



Hole 11 (Gold Tee) Par 3 - 90m

OB on cycleway behind basket and beyond.



Hole 12 (Black Tee) Par 4 - 130m

Mando to left of marked tree, fenced off area approx 11m behind basket is OB.



Hole 13 (Blue Tee) Par 3 - 76m

Large drain and beyond to the left OB. Small drain in front of basket is OB. Path and beyond to the right is not OB.

